

Pro Pack Solutions, Inc.

(770) 554-1187
(877) 776-7225



INSTRUCTIONS FOR OPERATION OF POTDEVIN ROTARY PRESS

MOTOR NAME PLATE:

CHECK THE MOTOR NAME PLATE TO INSURE THAT POWER SOURCE IS COMPATIBLE WITH MOTOR SPECIFICATIONS.

WOODEN BLOCK:

REMOVE THE WOODEN BLOCK FROM BETWEEN THE UPPER AND LOWER ROLLER BEARINGS. (FOR SHIPPING ONLY)

BEFORE TURNING POWER ON:

MAKE CERTAIN THAT MOTOR SAFETY SWITCH IS IN THE OFF POSITION BEFORE PLUGGING ELECTRICAL CORD INTO ELECTRICAL OUTLET.

SAFETY THROW-OFF HANDLEBAR:

THE HANDLEBAR IS TO DISENGAGE OR TO SEPARATE THE UPPER ROLLER FROM THE LOWER ROLLER QUICKLY SHOULD THE OCCASION ARISE.

MOTOR SAFETY SWITCH:

THE MOTOR SAFETY SWITCH ON THIS MACHINE HAS A BUILT-IN OVERLOAD MOTOR PROTECTOR WITH HAND RESET.

TO ADJUST TENSION:

MOTOR SAFETY SWITCH SHOULD BE IN OFF POSITION. THE SAFETY THROW-OFF HANDLEBAR SHOULD BE IN DOWN POSITION. ADJUST PRESSURE BETWEEN UPPER AND LOWER ROLLERS AS FOLLOWS: LOOSEN THE LOCKNUT COUNTER CLOCKWISE. NEXT ADJUST THE KNOB CLOCKWISE TO INCREASE PRESSURE AND COUNTER CLOCKWISE TO DECREASE PRESSURE.

INSERT A CORNER OF THE MATERIALS TO BE COMBINED BETWEEN THE ROLLERS AT ONE END. ADJUST FOR LIGHT PRESSURE, REPEAT AT OPPOSITE END OF ROLLERS. LIGHT PRESSURE EVENLY APPLIED ACROSS THE LENGTH OF THE ROLLERS USUALLY GIVE BEST RESULTS. TIGHTEN THE LOCKNUT AGAINST THE FRAME BY TURNING CLOCKWISE TO HOLD ADJUSTMENT.

CLEANING:

WHEN CLEANING MAKE CERTAIN THE MOTOR SAFETY SWITCH IS IN THE OFF POSITION. LIFT THE SAFETY THROW-OFF HANDLEBAR, TURN THE HAND-WHEEL COUNTER CLOCKWISE. CLEAN ROLLERS AT THE BACK END OF THE ROTARY PRESS.

BEFORE TURNING THE POWER ON:

WIPE THE ROLLER WITH A CLEAN CLOTH.

GUARDING:

ALL ROLLER WITH A CLEAN CLOTH.

SAFETY THRO-OFF HANDLEBAR:

PULL THE HANDLE BAR DOWN TO LOWER THE TOP ROLLER IN POSITION TO APPLY PRESSURE. THE HANDLEBAR WILL LOCK IN PLACE. WHEN THE PRESS IS NOT IN USE, RAISE THIS HANDLEBAR TO PREVENT THE ROLLERS FROM HAVING A FLAT SPOT DUE TO PRLONGED PRESSURE ON ONE POSITION. THIS HANDLEBAR CAN BE RAISED INSTANTLY IF IT BECOMES NECESSARY.

FOR USE WITH GLUING MACHINE:

THE BEST LAYOUT FOR THE GLUING MACHINE AND PRESS WILL BE TO HAVE THE GLUING MACHINE AT ONE END OF THE WORK BENCH AND THE PRESS NEAR THE OTHER END. THE MOUNTING CAN BE DONE AT THE CENTER. A BENCH 8 FT. OR 10 FT. LNG SHOULD BE AMPLE.

MOUNTING LITHOGRAPHS, SHEETS OR PHOTOGRAPHS:

IT IS VERY ESSENTIAL THAT A THIN COATING OF STICKY COLD OR HOT GLUE IS USED. DO NOT ATTEMPT TO USE WATERY GLUE OR PASTE AS THE BEST RESULTS CANNOT BE OBTAINED.

HAVE HE GLUING MACHINE ADJUSTED TO APPLY A THIN, UNIFORM COATING TO THE SHEETS. HAVE THE SPRING ADJUSTING SCREWS TIGHTENED EVENLY ABOUT 2/3 DOWN.

IF THE PAPER AND CARDBOARD SHEETS ARE SLIGHTLY DIFFERENT IN SIZE, THE SMALLER SHEET SHOULD BE GLUED. A POTDEVIN GLUING MACHINE WITH CARDBOARD ATTACHMENT WILL GLUE CARDBOARD OR PAPER SHEETS.

OFTEN IT IS DESIRABLE TO REVERSE THE ABOVE PROCEDURE BY PLACING THE CARDBOARD SHEET IN THE GUAGE FIRST AND PLACING THE PAPER SHEET ON TOPOF IT. THIS METHOD WORKS BEST WITH SMALL SHEETS. ANOTHER METHOD IS TO LAY OUT ABOUT SIX CARDBOARD SHEETS ON THE WORK BENCH, GLUE SIX PAPER SHEETS AND LAY THEM GLUED SIDE UP OM THE CARDBOARD SHEETS. AFTER THE SIXTH SHEET IS GLUED AND PLACED ON THE CARDBOARD SHEET,

THE WORKER SHOULD THEN TAKE THE FIRST SET OF SHEETS AND MOUNT THE GLUED SHEET ON THE CARDBOARD.

IMPORTANT:

DO NOT ATTEMPT TO SMOOTH THE PAPER SHEETS ALL OVER THE BOARD BY HAND. ONLY PRESS ON THE EDGE OF THE TWO SHEETS TOGETHER. ALWAYS SQUEEZE ONE OF THE EDGES WHICH IS AT RIGHT ANGLES TO THE GRAIN IN THE PAPER. THEN LEAVE THE REST OF THE PAPER SHEET LOOSE ON THE BOARD.

THE MOUNTED SHEETS SHOULD BE PUT THROUGH THE PRESS WITH THE JOINED EDGE OF THE MOUNTED SHEET FED FIRST. THE SECOND SET OF SHEETS ARE THEN MOUNTED IN THE SAME WAY AND SO ON.

THE ABOVE OPERATIONS CAN BE EASILY DONE BY ONE WORKER WITHOUT ASSISTANCE. IF THE SHEETS ARE LARGER THAN 17" X 2", IT MIGHT BE BEST TO HAVE TWO WORKERS TO HANDLE THE PAPER SHEETS.

IF A THIN COATING OF HOT ANIMAL GLUE IS USED, YOU WILL FIND THAT THE GLUED PAPER SHEETS CAN BE PLACED ON THE CARDBOARD IMMEDIATELY AFTER RECEIPT FROM THE GLUER AND THE REST OF THE OPERATIONS SHOULD BE AS DESCRIBED ABOVE.

THE GLUING MACHINE AND THE PRESS HAVE NOTHING TO DO WITH THE PAPER WRINKLING AS IT IS ALL UP TO THE GLUE COATING AND TEMPERING TIME.

DO NOT, UNDER ANY CIRCUMSTANCES, PRESS THE PAPER TO THE CARDBOARD EXCEPT AT THE FIRST EDGE WHICH WILL PASS THROUGH THE ROTARY PRESS. THE PAPER SHOULD LAY RATHER LOOSELY ON THE BOARD.

WHEN THE COMBINED SHEETS ARE PASSED THROUGH, THE PRESS WILL SMOOTH AND PRESS THE PAPER ON THE BOARD, WRINKLES AND BLISTERS WILL RESULT.

PRESSING BOOK COVERS:

AFTER THE BOOK CLOTH IS ATTACHED TO THE CARDBOARD SHEET AND TURNED IN, THE COVER SHOULD BE PASSED THROUGH THE PRESS.

PLEASE PERMIT US TO CO-OPERATE WITH YOU AND LET US KNOW IF YOU HAVE ANY DIFFICULTIES WHEN USING OUR MACHINE AND PRESS.

W-TYPE

W THRU W

LUBRICATING INSTRUCTIONS

OIL DAILY

USE SAE-40

OIL

KEEP MACHINE CLEAN

OIL DAILY

USE SAE-40

OIL

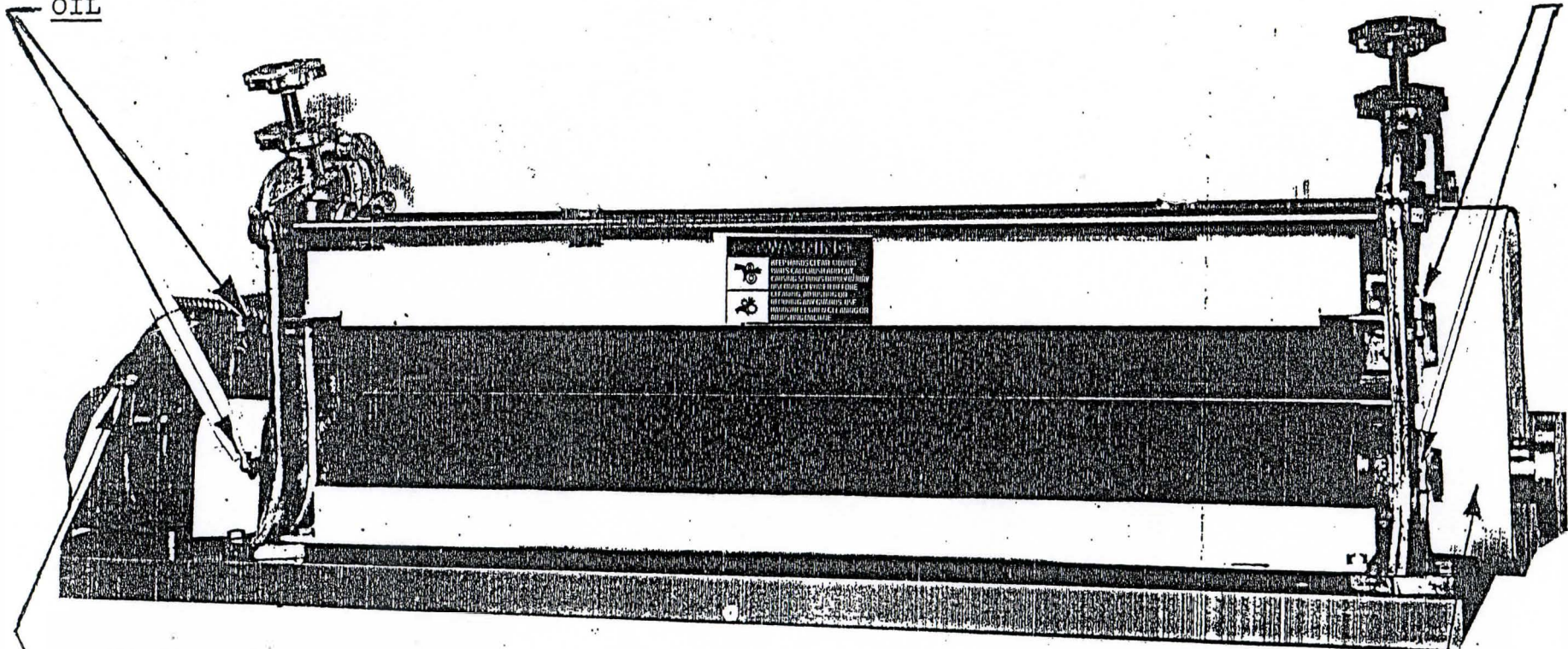

LUBE INFO FOR

RIGHT ANGLE GEAR UNITS.

OIL CAPACITY: 3/4 1 QT APPROX

OIL TYPE: 7 EP 15 - 50° F

8 EP 50 - 125 ° F

CHANGE OF OIL: TWICE YEARLY

AFTER CHANGE FIRST WEEK

FILL TO PROPER LEVEL

GREASE GEARS

ONCE A WEEK

USE HEAVY GREASE

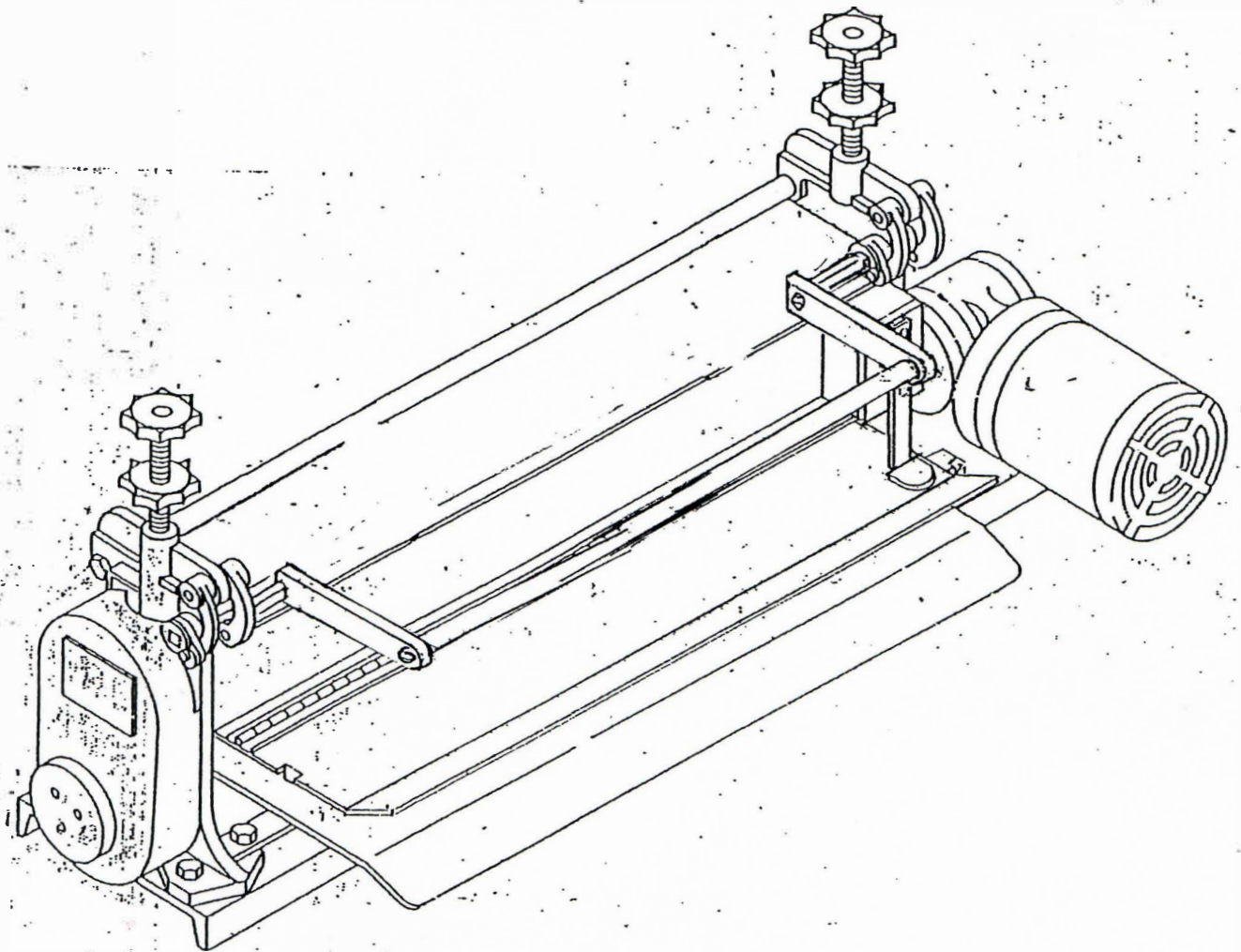

POTDEVIN
ROTARY PRESS
W24 THRU W60

Pro Pack Solutions, Inc.

(770) 554-1187
(877) 776-7225

Pro Pack Solutions, Inc.

(770) 554-1187

(877) 776-7225

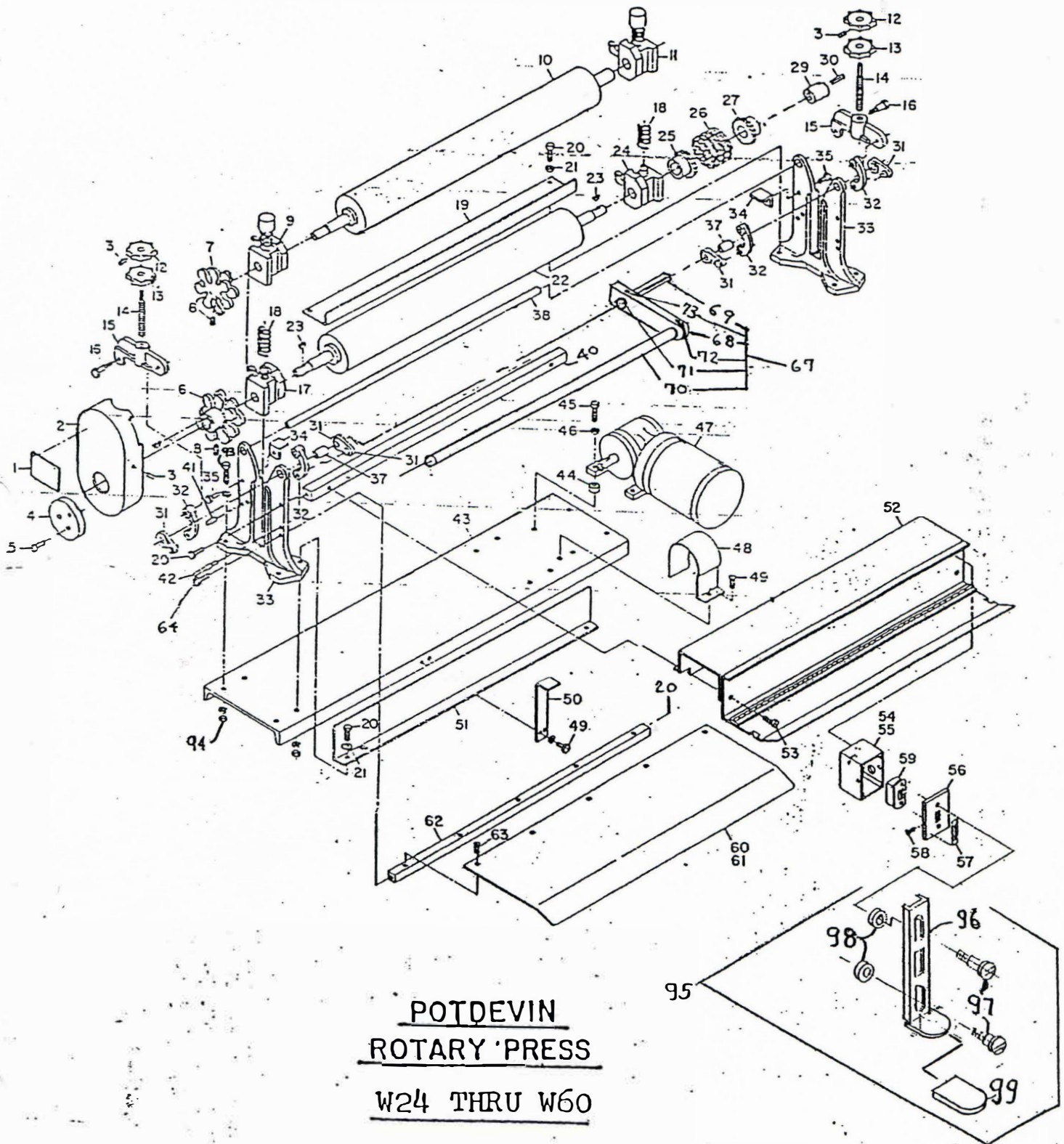

POTDEVIN
ROTARY PRESS
W24 THRU W60

Pro Pack Solutions, Inc.

(770) 554-1187

(877) 776-7225

POTDEVIN ROTARY PRESS PARTS LIST (24, 30, 36, 42, 54, AND 60 INCH WIDTHS)

ITEM	PART NUMBER	DESCRIPTION	QUANTITY
1.	W30-75A	NAME PLATE	1
2.	W30-14A	GEAR GUARD	1
3.		SETSCREW, 1/4-20 X 1/2" LONG	3
4.	W30-301A	HAND WHEEL	1
5.		SOCKET HEAD SCREW 10/32 X 7/8" LONG	3
6.	W30-12A	PRESSURE ROLLER GEAR (WITH HUB)	1
7.	W30-12	PRESSURE ROLLER GEAR	1
8.		SETSCREW, 5/16-18 X 1/2" LONG	2
9.	W30-52	UPPER BEARING ASSEMBLY, LEFT-HAND	1
10.*	WXX-6	UPPER ROLLER	1
11.	W30-52	UPPER BEARING ASSEMBLY, RIGHT-HAND	1
12.	W30-25P	TENSION SCREW KNOB	2
13.	W30-127P	LOCK KNOB	2
14.	W30-87	ADJUSTMENT SCREW	2
15.	W30-2	FRAME CAP	2
16.	W30-37	PIVOT SCREW	2
17.	W30-53	LOWER BEARING ASSEMBLY, LEFT-HAND	1
18.	WXX-9	LOWER ROLLER SPRING (W24 THRU W42)	2
18.	W60-9B	LOWER ROLLER SPRING (W48 THRU W60)	2
19.*	WXX-126B	LOWER BACK GUARD	1
20.		SCREW; HEX HEAD, 3/8-16 X 1" LONG	9
21.		LOCKWASHER, 3/8" LONG	6
22.*	WXX-5	LOWER ROLLER	1
23.		WOODRUFF KEY, NO. 91 (1/4" WIDE)	3
24.	W30-53	LOWER BEARING ASSEMBLY, RIGHT-HAND	1
25.	W30-261B-1	COUPLING, 1" BORE	1
26.	W30-261B-2	COUPLING CHAIN	1
27.	W30-312	SPROCKET, CLUTCH COUPLING ASS'Y	1
28.			
29.	W30-310	MOTOR SLEEVE ASS'Y	1
30.	W30-316A	SQUARE KEY 3/16 X 1" LONG	1
31.	W30-30	LOCK LEVER	4
32.	W30-34	LOCK LEVER LINK	4
33.	W30-1	FRAME	2
34.	W30-307	UPPER GUARD SUPPORT	2
35.		SCREW, HEX HEAD, 3/8-16 X 3/4" LONG	2
37.	W30-48	LOCK LEVER BUSHING	2
38.*	WXX-3	TIE BAR	1
40.*	WXX-23A	FRONT GUARD SUPPORT BAR (W54 THRU W60)	1
40.*	WXX-23B	FRONT GUARD SUPPORT BAR (W24 THRU W48)	1
41.	W30-68	GEAR GUARD SUPPORT PIN	1
42.	W30-15	GEAR GUARD SUPPORT STUD	1
43.*	WXX-4B	BASE	1
44.	W30-200D	MOTOR SPACER	4
45.		SCREW, HEX HEAD, 5/16-18 X 1 1/2" LONG	4
46.		LOCKWASHER, 5/16" LONG	4

POTDEVIN ROTARY PRESS PARTS LIST (CONT'D)
 (24, 30, 36, 42, 54, and 60 INCH WIDTHS)

ITEM	PART NUMBER	DESCRIPTION	QUANTITY
47.	EL-1012	MOTOR, 1/3 HP, 115/208-230 V. GEAR-	1
		MOTOR (USED ON W24, W30 ONLY)	
47. or	EL-1013	MOTOR, 1/2 HP, 115/208-230 V. GEAR-	1
		MOTOR (USED ON W36 THRU W60)	
	<u>OPTIONAL - MOTORS</u>		
47. or	W30-306	MOTOR - 1/2 HP, 115/230V, VARI/SP.	1
47. or	EL-831	MOTOR - 3/4 HP, 115, DC VARI/SP.	1
48.	W30-84A	COUPLING DRIVE GUARD	1
49.		SCREW, 1/4-20 X 1/2 ROUND HEAD	3 OR 5
50.	W30-277A	FEED TABLE BRACE	
		(WIDTH 24, 30, 36)	1
		(WIDTH 42, 48, 54, 60)	2
51.*	WXX-300	LOWER FRONT GUARD	1
52.*	WXX-22EL	W-MACHINE ELECTRICAL GUARD	1
53.		SCREW, 1/4-20 X 3/4 - FILLISTER HEAD	2
54.	EL-833	BOX AND COVER ASSEMBLY	1
		(INCLUDES ITEMS 55, 56, 57 AND 58)	
55.	EL-834	BOX, ELECTRICAL	1
56.	EL-835	ELECTRICAL BOX COVER	1
57.	EL-836	DECAL, OFF-ON	1
58.		SCREW, PAN HEAD, NO. 6 X 3/8	2
59.	EL-1028-115	SWITCH, 115 V	1
59. or	EL-1028-230	SWITCH, 230 V	1
60.*	WXX-56B	FEED TABLE ASSEMBLY	1
		(INCLUDES ITEMS 61, 62 AND 63)	
61.*	WXX-20B	FEED TABLE	1
62.*	WXX-21A	FEED TABLE SUPPORT BAR	1
63.		SCREW, FLAT HEAD, NO. 8-32 X 3/8	5
		(AS REQ'D.)	
64.		BUTTON HEAD SCREW 3/8 - 16 X 1	1
67.*	WXX-103	ASS'Y OF LOCK LEVER	1
		(INCLUDES ITEMS 68, 69, 70*, 71, 72, & 73)	
68.	W70-100	HANDLE BAR	2
69.	W70-101	LOCK LEVER STUD	2
70.*	WXX-102	HANDLE	1
71.	W70-105	BUSHING	2
72		ROLL PIN, 1/8 DIA. X 1 1/4 LG.	2
73		SET SCREW, 5/16 - 18 X 1/4 LG., CUP POINT.	2
93.		SCREW, 3/8-16 X 1-1/4 HEX HEAD	2
94.		NUT, 3/8-16 HEX HEAD	2
95.	EL-1044	OFF ACTUATOR ASSY (INCLUDES ITEMS	1
		96, 97, 98, and 99)	
96.	EL-1029	OFF ACTUATOR	1
97.	EL-1040	TIE DOWN SCREW	2
98.	EL-1041	SPACER	2
99.	EL-1043	OFF ACTUATOR BOOT	1

* SUBSTITUTE PRESS WIDTH IN INCHES FOR XX IN PART NUMBER
 FOR EXAMPLE: UPPER ROLLER (ITEM 10) PART # FOR 54" PRESS IS W54-6